

PENN TOWNSHIP SECTION 12 R 12 TWP 9 MORGAN COUNTY, OHIO

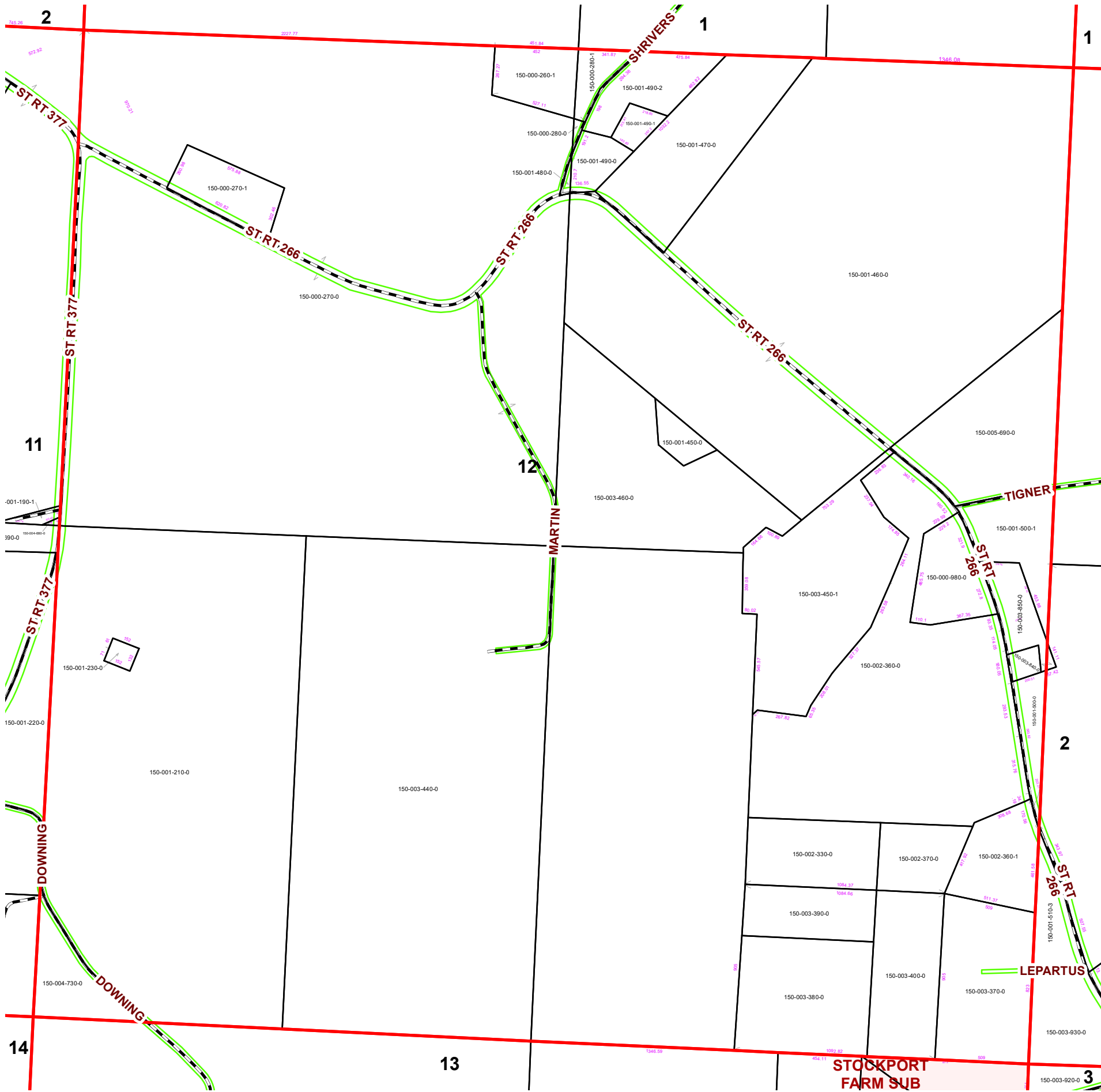

PIN	Owner	LegalDescr	Acres	VOL	PAGE	Survey_Ref
150-001-500-0	COOLEY GARY D & ORLETA M TOD G	R12 T09 S12 SD 9 SUR	1.99	OR231	5315	PEN-0078.pdf
150-001-500-1	COOLEY GARY D & ORLETA M TOD G	R12 T09 S12 SD 31 SUR	0.83	OR231	5315	PEN-0078.pdf
150-001-210-0	DEARTH FARMS LLC	R12 T09 S12 SD 4-5-11	76.54	OR235	5756	NoSurvey.pdf
150-000-280-0	DEARTH FARMS LLC & KEVIN T JENNE	R12 T09 S12 SD 17 UND	0.114	OR235	5760	PEN-0160.pdf
150-000-270-0	DEARTH FARMS LLC & KEVIN T JENNE	R12 T09 S12 SD 15-16	160.38	OR235	5760	NoSurvey.pdf
150-000-980-0	DERBY JOHN E	R12 T09 S12 SD 26	4.26	D.V 201	459	PEN-0062.pdf
150-000-280-1	DILLE JEFFREY D & JESSICA L	R12 T09 S12 SD 32 SUR	1.61	OR228	1277	PEN-0124.pdf
150-000-260-1	DILLE JEFFREY D & JESSICA L	R12 T09 S12 SD 33 SUR	3.393	OR228	1277	PEN-0124.pdf
150-001-490-1	EARICH CHRIS M & BREA D	R12 T09 S12 SD 36 SUR	0.96	OR89	384	PEN-0186.pdf
150-001-490-2	EARICH CHRIS M & BREA D	R12 T09 S12 SD 37 SUR	4.04	OR131	794	PEN-0209.pdf
150-001-470-0	EARICH CHRISTOPHER MATTHEW	R12 T09 S12 SD 12	11.737	OR45	750	PEN-0067.pdf
150-003-380-0	FISHER DAVID G & KELLY A	R12 T09 S12 SD 20 SUR	10.35	D.V 197	266	PEN-0045.pdf
150-003-370-0	FISHER DAVID G & KELLY A	R12 T09 S12 SD 25 SUR	10.08	D.V 197	266	PEN-0045.pdf
150-003-400-0	FISHER DAVID G & KELLY A	R12 T09 S12 SD 28 SUR	7.68	D.V 197	266	PEN-0045.pdf
150-003-390-0	FISHER DAVID G & KELLY A	R12 T09 S12 SD 29 SUR	4.59	D.V 197	266	PEN-0045.pdf
150-001-490-0	GEARY ROBERT V & JANICE E	R12 T09 S12 SD 30 SUR	1.675	OR177	54	PEN-0050.pdf
150-000-270-1	GREER CHARLES O	R12 T09 S12 SD 34	3.843	OR128	489	PEN-0156.pdf
150-001-230-0	JENNE ORRY I	R12 T09 S12 SD 27	0.46	OR235	5748	PEN-0277.pdf
150-003-440-0	MARTIN RITA J	R12 T09 S12 SD 6	82	OR174	374	NoSurvey.pdf
150-003-450-0	MARTIN RITA J	R12 T09 S12 SD 7	66.367	OR174	374	NoSurvey.pdf
150-003-460-0	MARTIN RITA J	R12 T09 S12 SD 13	19.472	OR174	374	NoSurvey.pdf
150-001-450-0	MCCONKEY JAMES H & SARA L	R12 T09 S12 SD 24 SUR	1.3	OR218	2172	NoSurvey.pdf
150-001-480-0	MCCONKEY JAMES H & SARA L	R12 T09 S12 SD 19 SUR	0.09	OR218	2172	NoSurvey.pdf
150-001-460-0	MCCONKEY JAMES H & SARA L	R12 T09 S12 SD 1 SUR	99.81	OR218	2172	NoSurvey.pdf
150-003-840-0	MCGREW PEARLE ELEANOR TOD-DAR	R12 T09 S12 SD 22	0.59	OR176	747	NoSurvey.pdf
150-003-850-0	MCGREW PEARLE ELEANOR TOD-DAR	R12 T09 S12 SD 23	2.9	OR176	747	NoSurvey.pdf
150-004-730-0	QUEEN EARL W	R12 T09 S11 SD 14	4.5	OR228	269	NoSurvey.pdf
150-005-690-0	TIGNER DALE E & SANDI	R12 T09 S12 SD 2 SUR	16.01	D.V 205	112	NoSurvey.pdf
150-002-360-1	YOUNG JEREMY B & CARRIE A	R12 T09 S12 SD 35 SUR	4.95	OR77	443	PEN-0179.pdf
150-003-450-1	YOUNG JEREMY B & CARRIE A	R12 T09 S12 SD 38	16.373	OR233	514	PEN-0339.pdf
150-002-370-0	YOUNG WILMA JO	R12 T09 S12 SD 10	3.12	OR180	485	PEN-0108.pdf
150-002-330-0	YOUNG WILMA JO	R12 T09 S12 SD 18	6.03	OR180	485	PEN-0108.pdf
150-002-360-0	YOUNG WILMA JO	R12 T09 S12 SD 8-21	35.397	OR180	485	PEN-0108.pdf

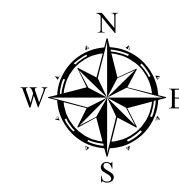

Boundaries			
	Hydro		Section
	Roads		Lot
	County		Township
	Parcel		ROW



Disclaimer: The information that these maps contains is for reference purposes only. Please bring any erros to the attention of the Engineer's Office staff. Thank you

